

# ATP22 Series

## Anti-Vandal Sealed Pushbutton Switch



### Agency Approvals

Agency	Agency File Number
US	E42363

### Specifications

<b>Function</b>	Single pole and double poles
<b>Contact Arrangement</b>	N.O. And N.C.
<b>Mounting Type</b>	Threaded front panel mount
<b>Torque for Threaded Body</b>	5-14 Nm

### Mechanical Characteristics

<b>Mechanical Life</b>	Momentary 1,000,000 cycles Self-lock 500,000 cycles
<b>Total Travel</b>	About 3.2 mm
<b>Operating Force</b>	1 pole 2.5 ± 1N 2 pole 3.5 ± 1N

### Electrical Characteristics

<b>Contact Rating</b>	1th 5A/250VAC 3A / 250VAC 3A / 28VDC
<b>Operating Life</b>	50,000 make-and-break cycles at full load
<b>Dielectric Strength</b>	2,000 V RMS @ sea level
<b>Insulation Resistance</b>	1,000 MΩ min. @ 500 VDC
<b>Initial Contact Resistance</b>	50 mΩ max @ 1A 12 VDC
<b>Operating Temperature</b>	-20°C to 55°C
<b>Sealing / Protection</b>	IP67 / IK10 (Stainless steel bushing)

### Description

The ATP22 series is an anti-vandal sealed pushbutton switch offers the industry standard ring illuminated pushbutton in 22 mm diameter. The anti-vandal switches use a scratch resistant actuator and housings are made of robust stainless steel particularly suitable for use in equipment subjected to harsh conditions or applications that require protection from vandalism. The 22 mm pushbuttons meet the seal protection and impact resistance ratings of IP67 and IK10 that design to withstand the possible extreme outdoor environmental and may subject to abuse. Also, the ATP22 comes with a variety of LED colors and various of indicators on the actuator that meet your application needs.

### Features & Benefits

- Momentary or Lock version
- IP67 sealed & IK10 (Stainless steel bushing)
- Capable of up to 3A resistive load
- 50,000 life cycle at full load
- Various colors of LED illuminate indicator
- Choices of pushbutton with symbol on spot, ring or power logo

### Applications

- Control Panels including car park and traffic light
- Industrial Instruments
- Lifts / Escalator
- Communication equipment
- Alarm, safety and security systems

### Materials

<b>Bushing</b>	Stainless steel
<b>Base</b>	PBT (UL 94 V-0), PC (UL 94 V-2)
<b>Actuator</b>	PC; Stainless steel / Aluminum alloy
<b>Internal Assembly</b>	POM / PA66
<b>Spring</b>	Steel
<b>Sealing / O-ring</b>	Silicone
<b>Terminals</b>	Brass, silver or gold flash plated
<b>Contact</b>	Brass, coin silver, silver or gold flash plated

#### Notes:

Specifications and materials listed above are for switches with standard options. For information on specific and custom switches, please contact Customer Service.

# ATP22 Series

## Anti-Vandal Sealed Pushbutton Switch



### Ordering Number

To order, simply select desired option from each category and place in the appropriate box.

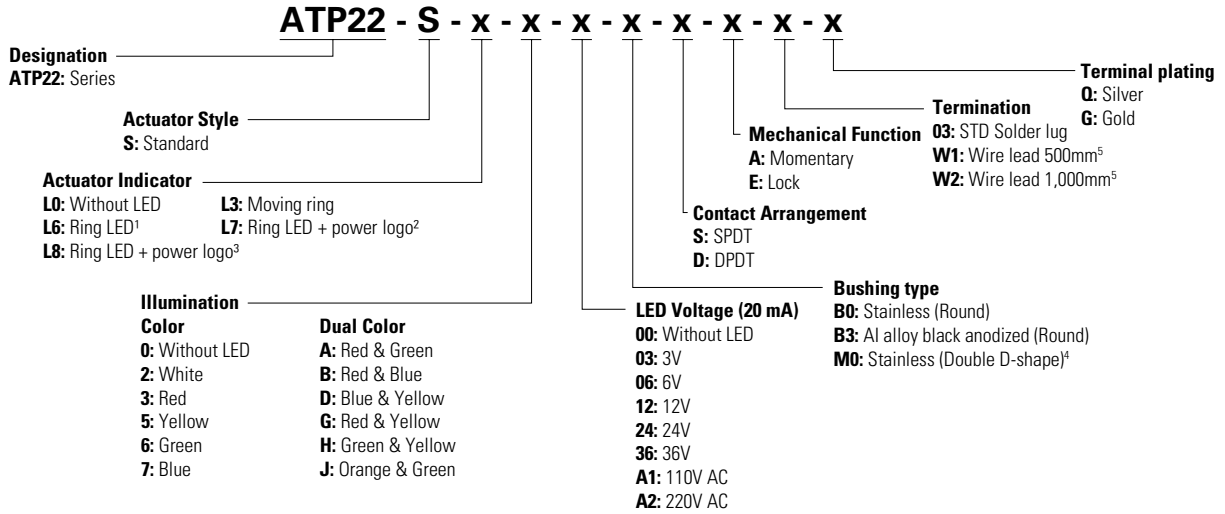

- Notes:**
1. Available on ring color CAP of red/green/blue only
  2. Power logo and ring with clear color CAP available on double D-shape bushing only
  3. Power logo and ring with red/green/blue color CAP available on double D-shape bushing only
  4. Not available on L0/L3/L6 actuator indicator
  5. Available upon request, please contact your sales representative for details

### Standard View inches (mm)

#### Round Bushing

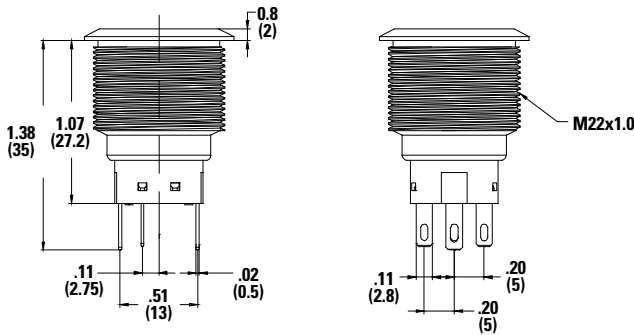

#### Double-D Bushing

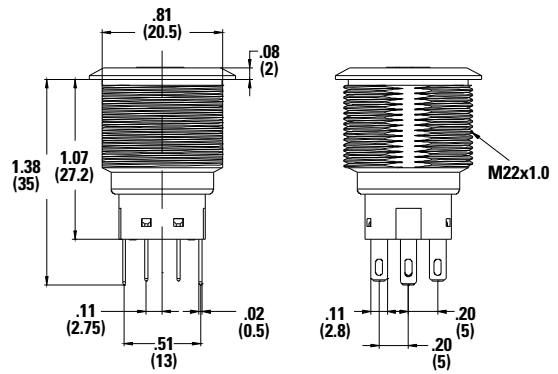

# ATP22 Series

## Anti-Vandal Sealed Pushbutton Switch



Actuator Style  
S Standard

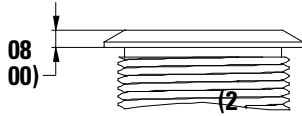

Actuator Indicator inches (mm)  
L0 Without LED

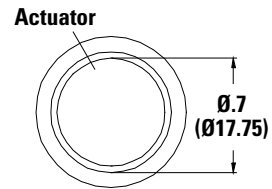

L3 & L6 Ring LED

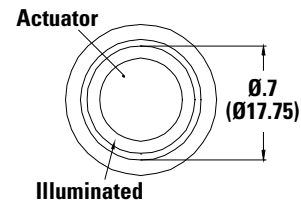

L7 & L8 Power & Ring

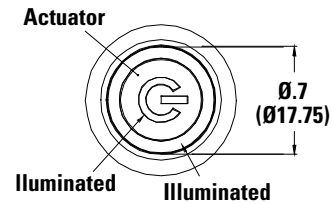

Circuit

SPST

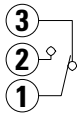

SPDT - Single Color LED

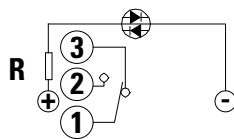

SPDT - Dual Color LED

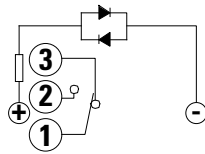

DPDT

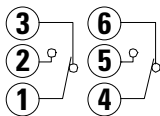

DPDT - Single Color LED

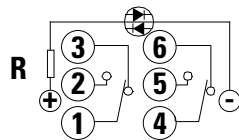

DPDT - Dual Color LED

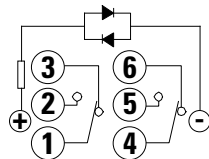

Termination inches (mm)

03 Solder Lug

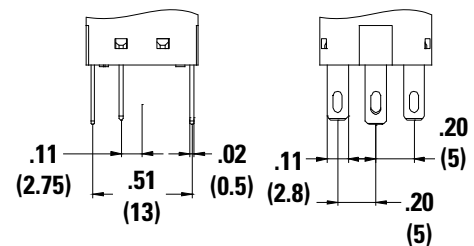

# ATP22 Series

## Anti-Vandal Sealed Pushbutton Switch



### W1 or W2 Wire Lead

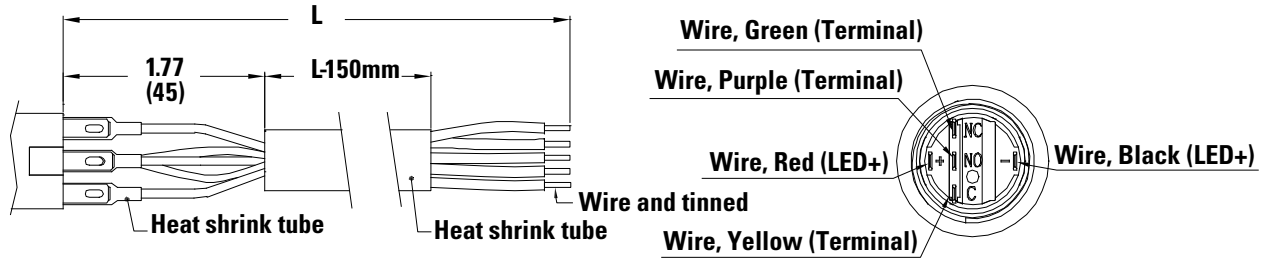

### Hardware inches (mm)

**Hex Nut**  
Order PN: ATP22-HN

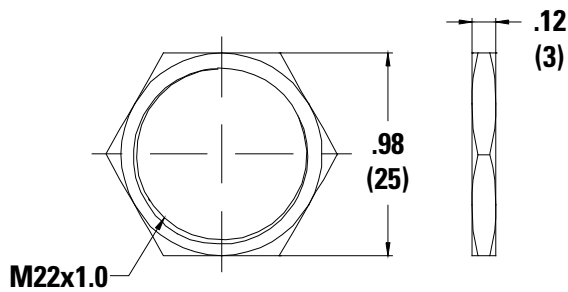

**O Ring**  
Order PN: ATP22-OR

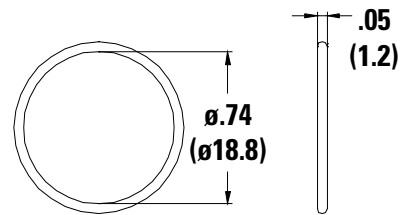

**Disclaimer Notice** - Information furnished is believed to be accurate and reliable. However, users should independently evaluate the suitability of and test each product selected for their own applications. Littelfuse products are not designed for, and may not be used in, all applications. Read complete Disclaimer Notice at <http://www.littelfuse.com/disclaimer-electronics>.