

S Series

Slide Switches



Agency Approvals

Agency	Agency File Number
c US	E42363

Specifications

Contact Rating	Q contact material (S1XX, S2XX models): 6 amps @ 125 V AC; 6 amps @ 250 V AC; 1 amp @ 125 V DC . (S5XX, S6XX models): 12 amps @ 125 V AC; 6 amps @ 250 V AC; 1 amp @ 125 V DC . (S7XX, S8XX models): 15 amps @ 125 V AC; 6 amps @ 250 V AC .
Electrical Life	10,000 make-and-break cycles at full load.
Contact Resistance	Below 10 m Ω typ. initial @ 2-4 V DC, 100 mA, for both silver and gold plated contacts.
Insulation Resistance	10 ⁹ Ω min.
Dielectric Strength	1,000 Vrms min. @ sea level.
Operating Temperature	-30°C to 65°C
Storage Temperature	-30°C to 85°C

Description

Designers of portable tools, small appliances and floor care products turn to the S series switch when they need a resilient, long-lasting switch that can withstand harsh environments. The S series switch comes with enclosed housing, optional reversing option, PC or snap-in panel mounting and a range of 6 to 15 amps.

Features & Benefits

- 6 to 15 AMPS
- Enclosed housing
- PC and Snap-in panel mounting
- Reversing option
- RoHS compliant

Applications

- Portable tools
- Small appliances
- Floor care products

Materials

Housing & Top Plate	6/6 nylon (UL 94 V-2), black.
Actuator	6/6 nylon (UL 94 V-2), black (standard).
Contacts	Q contact material: Copper, silver plated.
Terminals	
Contact Spring	Music wire or stainless steel.
Terminal Seal	Epoxy.

Notes:

Any models supplied with Q, B or G contact material are RoHS compliant. Specifications and materials listed above are for switches with standard options. For information on specific and custom switches, consult Customer Service Center.

S Series

Slide Switches



Ordering Number

Our easy build-a-switch concept allows you to mix and match options to create the switch you need. To order, select desired option from each category and place it in the appropriate box.

Sx - x - x - x - x - x - x - x

<p>Switch Function</p> <p>S101: SPST, 6 amps S202: (DPDT), 6 amps S802: DPDT, 15 amps S102: SPDT, 6 amps S112: SPDT, mom., 6 amps S201: DPST, 6 amps S602: DPDT, 12 amps S701: SPST, 15 amps S702: SPDT, 15 amps</p>	<p>Actuator</p> <p>03: 0.335" high 04: 0.500" high 09: 0.250" high 12: Screwdriver slot (with marking) 13: Screwdriver slot (without marking) C2: Black cap C3: Red cap C5: Yellow cap</p>	<p>Seal</p> <p>None: No seal E: Epoxy seal</p>	<p>Contact Material</p> <p>B: Gold Q: Silver G: Gold over silver</p>
<p>Detent</p> <p>1: With detent 2: Without detent</p>	<p>Mounting Style</p> <p>SS: Panel with mounting ears MS: PC thru-hole S2: Snap-in panel with blacktop plate TS: Panel with mounting ears</p>	<p>Terminations</p> <p>03: Solder lug with hole 02: PC Thru-hole 04: PC Thru-hole 07: Quick connect 08: PC Thru-hole WC: Wire lead</p>	

Switch Function

No. Poles	Model No.	AMP Rating	Switch Function	Schematic	Available Mounting Styles
SP	S101	6	SPST		SS
	S102		SPDT		MS, SS
	S112		SPDT-MOM.		
SP	S701	15	SPST		S1, S2, S3, ST
	S702		SPDT		

No. Poles	Model No.	AMP Rating	Switch Function	Schematic	Available Mounting Styles
DP	S201	6	DPST		MS, SS, TS
	S202		DPDT		
	S602			12	
DP	S802	15	DPDT		S1, S2, S3, ST

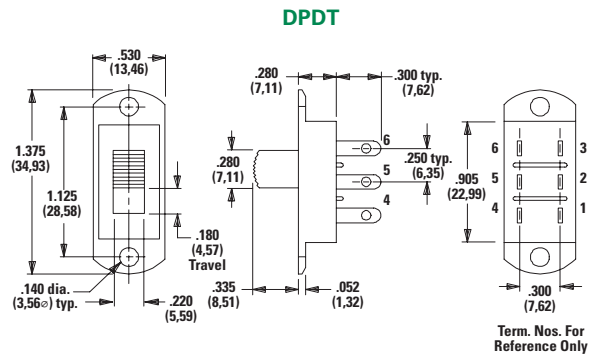
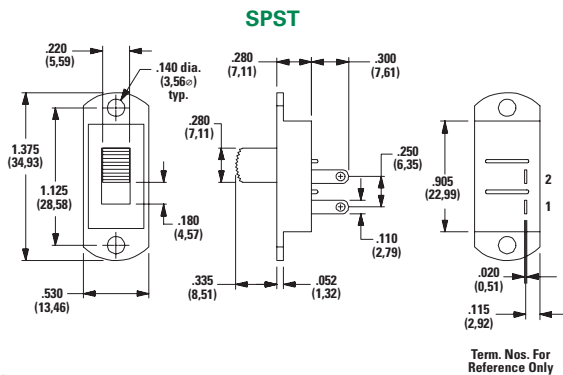

Notes:
 and MOM. in table indicates momentary action.
 All models can be used with all options when ordered with 'G' or 'Q' contact material.
 Contacts make on side actuator thrown.

S Series

Slide Switches



Actuator

03 0.335" High

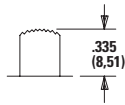

04 0.500" High

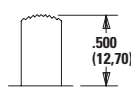

09 0.250" High

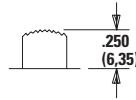

12 Screwdriver Slot (with marking)

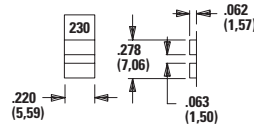

White 115-230 markings (std.).

13 Screwdriver Slot (without marking)

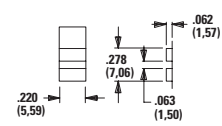

Without markings.

Notes:

Standard actuator color is black, other colors available, consult Customer Service Center. Alternate heights are available with '03, 04 and 09' actuators, consult Customer Service Center. Models with S2 mounting style, subtract 0.090 (2.29). Actuators '12' and '13' are available with DPST and DPDT models only.

C2; C3; C5 Snap-On Cap

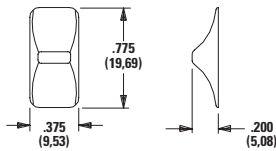

Note: Available with S2 mounting style only.

Option Code 2	C1-CT Cap Colors
C2	Black
C3	Red
C5	Yellow

Notes: Actuator finish: matte. If no color is specified, black will be supplied. Colored actuator caps may also be ordered separately and user installed, see page 5.

Detent

1 With Detent

Standard with all maintained models: S101, S102, S201, S202, S602, S701, S702, and S802.

2 Without Detent

Standard with all momentary models: S112.

S Series

Slide Switches



Mounting Styles

SS Panel with Mounting Ears
S202031SS03Q DPDT

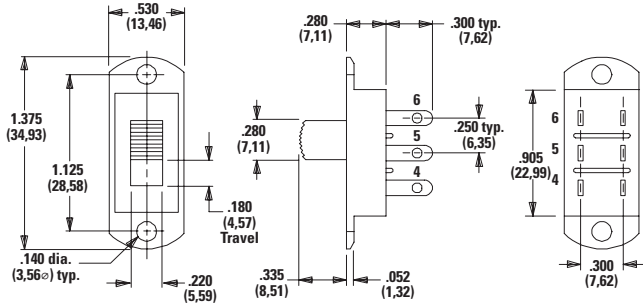

MS PC Thru-hole
S202031MS02Q DPDT

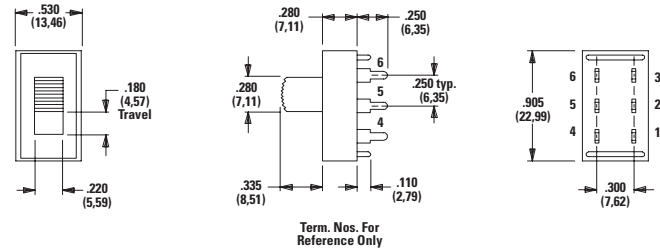

Available with:
Models: S101, S102, S112, S201, S202, S602
Terminations: 02, 04 and 08
Actuators: 03, 04, 09, 12¹ and 13¹, ¹12 and 13 actuators available with S201, S202 and S602 models only.
PC Mounting: For mounting information, see TERMINATIONS section.

Panel Mounting

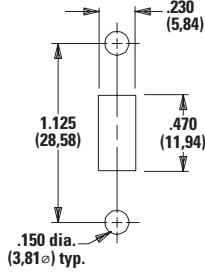

Available with:
Models: S101, S102, S112, S201, S202 and S602
Terminations: All except 08
Actuators: 03, 04, 09, 12¹ and 13¹. ¹12 and 13 actuators not available with S1XX models.

S2 Snap-in Panel
S802C21S207Q DPDT

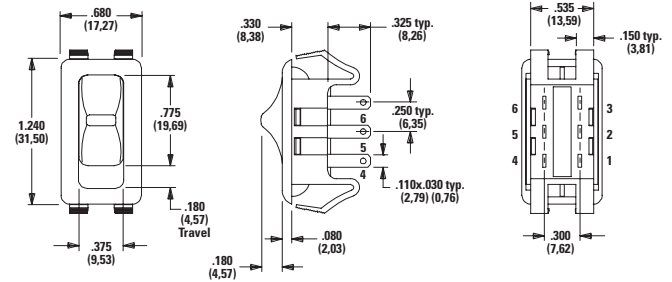

Panel Mounting

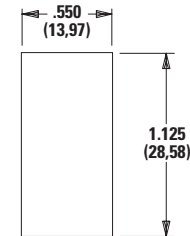

Available With:
Models: S701, S702, and S802
Terminations: 04, 07, 57 and WC
Actuators: C2, C3, C5 and 03

Panel Thickness:
.020(0,57) - .200(5,08)

S Series

Slide Switches



TS Panel with Mounting Ears S202031TS03Q DPDT

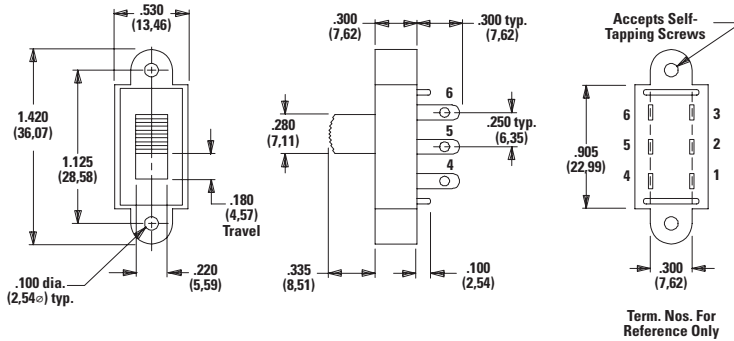

Panel Mounting

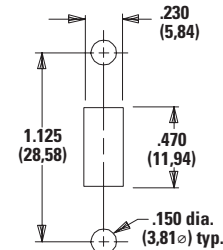

Available with:
Models: S201, S202, and S602
Terminations: All
Actuators: 03, 04 and 12.

Term. Nos. For Reference Only

Terminations

03 Solder Lug with Hole

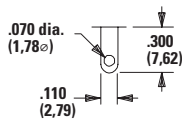

02 PC Thru-hole

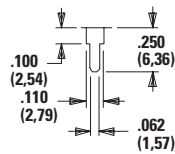

Recommended with 'MS' mounting style only.

04 PC Thru-hole

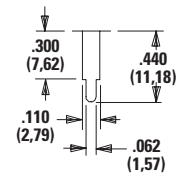

Recommended with double pole models only.

PC Mounting 02 & 04 Terminations

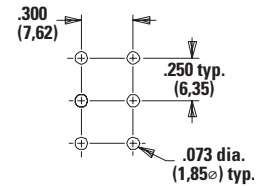

07 Quick Connect

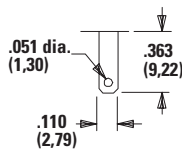

08 PC Thru-hole

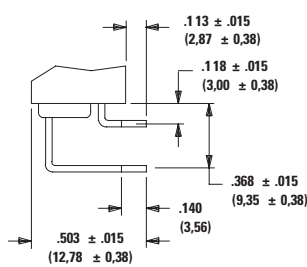

MS mounting style only.

WC Wire Lead

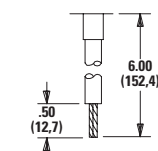

18 AWG wire for S1XX and S2XX models. 16 AWG wire for all other models. Black wire standard, other colors and lengths available, consult Customer Service Center. UL style 1015.

PC Mounting 08 Terminations with MS Mounting Style

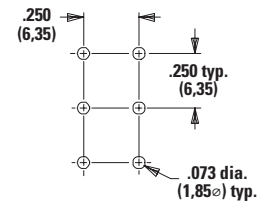

Notes: All terminals on S1XX, S2XX and S6XX models are 0.020 (0.51) thick; all terminals on S7XX and S8XX models are 0.031 (0.79) thick.

Top Plate Markings

None No Markings

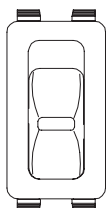

D On-Off

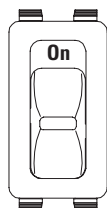

L On

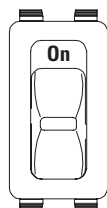

M On-Off

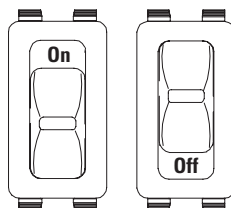

N Red Rectangle on One End

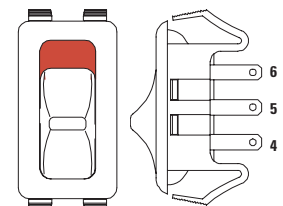

Note: Orientation of actuator markings and terminals.

Notes: Top plate markings are available with 'S2' mounting style only. The marking color on all top plates with marking options 'D, L and M' is white, standard. (except white top plates: marking color is black, standard). The marking color on all top plates with 'N' marking option is red, standard. Other marking colors are available, consult Customer Service Center.

S Series

Slide Switches



Contact Material

Option Code	Contact Material		Ratings
B	Gold ¹	Low Level / Dry Circuit	0.4 VA max. @ 20 V AC or DC max.
Q	Silver ²	Power	S1XX, S2XX models: 6 amps @ 125 V AC; 6 amps @ 250 V AC; 1 amp @ 125 V DC S6XX models: 12 amps @ 125 V AC; 6 amps @ 250 V AC; 1 amp @ 125 V DC S7XX, S8XX models: 15 amps @ 125 V AC; 6 amps @ 250 V AC
G	Gold over Silver ³	Low Level / Dry Level Circuit or Power	S1XX, S2XX models: 0.4 VA max. @ 20 V AC or DC max. or 6 amps @ 125 V AC; 6 amps @ 250 V AC; 1 amp @ 125 V DC S6XX models: 0.4 VA max. @ 20 V AC or DC max. or 12 amps @ 125 V AC; 6 amps @ 250 V AC; 1 amp @ 125 V DC S7XX, S8XX models: 0.4 VA max. @ 20 V AC or DC max. or 15 amps @ 125 V AC; 6 amps @ 250 V AC

Notes: See Technical Data section of this catalog for RoHS compliant and compatible definitions and specifications.

1. Contacts & Terminals: Copper, with gold plate over nickel plate.

2. Contacts & Terminals: Copper, silver plated (standard with all termination options).

3. Contacts & Terminals: Copper, with gold plate over nickel plate over silver plate.

Any models supplied with B, Q or G contact material are RoHS compliant.

All models with all options when ordered with 'G' or 'Q' contact material. 'G' contact material is equivalent to both 'B' and 'Q' contact materials.

Seal

E Epoxy Seal

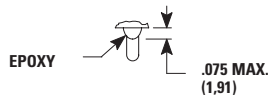

Available Hardware

Cap, C2; C3 actuators

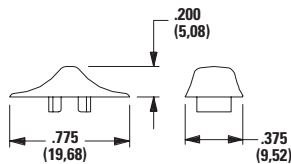

Part No.
 121160100 WHITE
 121160200 BLACK
 121160300 RED
Material: 6/6 Nylon
Finish: Matte

Cap, 03 actuators

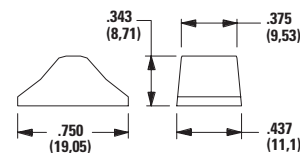

Part No.
 121000101 WHITE
 121000102 BLACK
 121000103 RED
Material: 6/6 Nylon
Finish: Gloss

Notes: Other colors available, consult Customer Service Center.

Disclaimer Notice - Information furnished is believed to be accurate and reliable. However, users should independently evaluate the suitability of and test each product selected for their own applications. Littelfuse products are not designed for, and may not be used in, all applications. Read complete Disclaimer Notice at <http://www.littelfuse.com/disclaimer-electronics>.